



Wow! I Made It.com

Armoire

This attractive and practical two-door armoire takes up very little floor space in a bedroom but provides lots of storage. Because it is only a little over 1 foot deep, it's easy to incorporate into almost any room, yet it conveniently keeps socks, sweaters, ties, and belts organized and handy.



Materials

- 6 linear feet of 1 x 1 pine
- 40 linear feet of 1 x 4
- 28 linear feet of 1 x 6
- 38 linear feet of 1 x 12
- 16 linear feet of 3-inch-wide crown molding
- 2 sheets (4' x 8') of ¼" plywood
- 4 porch post finials, 7-1/2 inches long*
- 2 linear feet of wooden closet rod (optional)

Hardware

- 110 ¾" wire brads
- 52 1-1/4" 3d finishing nails
- 40 2" 6d finishing nails
- 44 1" wood screws
- 110 1-1/2" wood screws
- 6 cabinet door hinges
- 2 door pulls
- 2 cabinet catches

Special Tools and Techniques

- Bar clamps or pipe clamps
- Miters
- Rabbits

Cutting List

Code	Description	Qty.	Materials	Dimensions
A	Top/Bottom	2	1 x 12 pine	42-1/4" long
B	Side	2	1 x 12 pine	61-1/4" long
C	Center Divider	1	1 x 12 pine	61-1/4" long
D	Shelf	8	1 x 12 pine	20" long
E	Shelf Support	6	1 x 1 pine	11-1/4" long
F	Back	1	¼" plywood	42-1/4" x 62-3/4"
G	Side Trim	4	1 x 4 pine	11-1/4" long
H	Front Trim	2	1 x 4 pine	43-3/4" long
I	Crown Molding	6	3" crown molding	Cut to fit
J	Drawer Front/Back	10	1 x 6 pine	19-7/8" long
K	Drawer Side	10	1 x 6 pine	9-5/8" long
L	Drawer Bottom	4	¼" plywood	10" x 18-3/4"
M	Top/Bottom Door Trim	4	1 x 4 pine	21" long

N	Side Door Trim	4	1 x 4 pine	61" long
O	Door Panel	2	1/4" plywood	14-1/2" x 54-1/2"
P	Leg	4	Porch post finials*	7-1/2" long

***Notes on Materials**

The legs for our armoire are actually porch post finials which we purchased in a building supply store. The exact shape doesn't matter, but they should be at least 7-1/2 inches long. If you can't find the exact finials that we used, you can lengthen the finials by attaching a 2 x 4 block under the lower trim on the armoire, and then attaching the finials to those blocks.

Building the Armoire Outer Case

1. Cut two top/bottoms (A) from 1 x 12 pine, each measuring 42-1/4 inches.
2. Cut two sides (B) from 1 x 12 pine, each measuring 61-1/4 inches long.

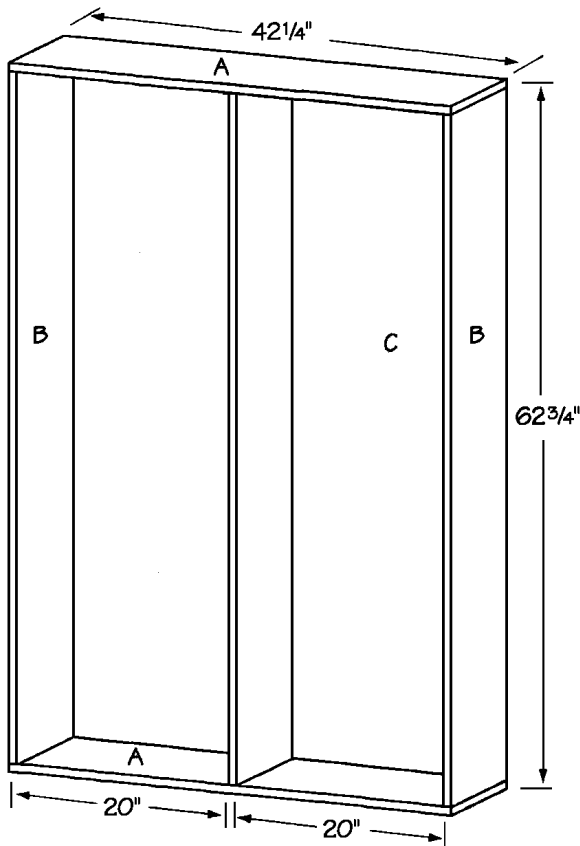

Figure 1

3. Place the two sides (B) on edge on a level surface, parallel to each other and 40-3/4 inches apart. Place the two top/bottoms (A) over the ends of the two sides (B), as shown in *Figure 1*. Screw through the top/bottoms (A) into the two sides (B) using four evenly spaced 1-1/2-inch screws on each joint.
4. Cut one center divider (C) from 1 x 12 pine, measuring 61-1/4 inches long.
5. Place the center divider (C) in the center of the armoire assembly, parallel to and 20 inches from each of the sides (B), as shown in *Figure 1*. Screw through the top/bottoms (A) into the center divider (C) using four evenly spaced 1-1/2-inch-long screws on each joint.
6. Cut eight shelves (D) from 1 x 12 pine, each measuring 20 inches long.

7. Refer to *Figure 2* to place five shelves (D) on the right side of the armoire case. Note that the upper shelf (D) is 28-3/4 inches below the top/bottom (A), and that the remaining four shelves (D) are spaced 5-3/4 inches apart. Screw through the side (B) and center divider (C) into the five shelves (D). Use four evenly spaced 1-1/2-inch-long screws on each joint.
8. Refer to *Figure 2* to place the three remaining shelves (D) on the left side of the armoire case. Note that the upper shelf (D) is 14-3/4 inches below the top/bottom (A), and that the remaining two shelves are spaced 14-3/4 inches apart. Apply glue on the meeting surfaces, and screw through the side (B) and center divider (C) into the three shelves (D). Use four evenly spaced 1-1/2" screws on each joint.

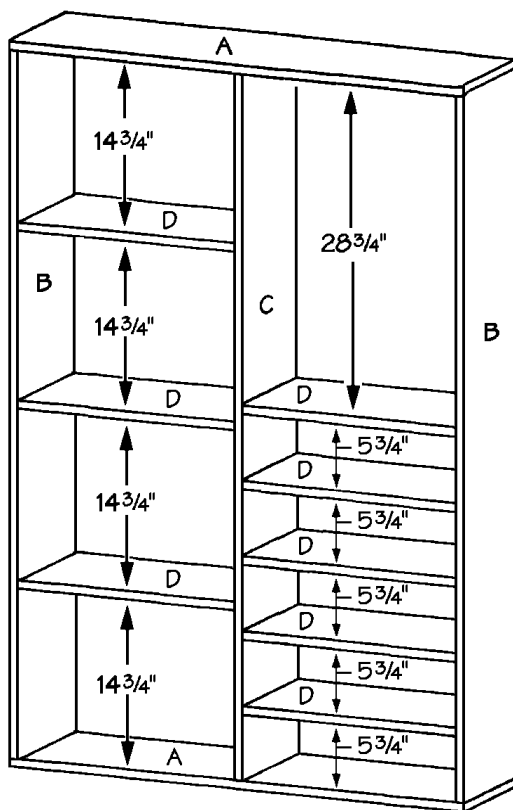

Figure 2

9. Cut six left shelf supports (E) from 1 x 1 pine, each measuring 11-1/4 inches long.
10. Glue and nail one shelf support (E) under the left side of the upper shelf (D), as shown in *Figure 3*. Apply glue on the meeting surfaces, and nail through the shelf support (E) into the shelf (D) and the side (B) using three 1-1/4-inch nails in each direction.
11. Repeat Step 10 five more times to install a shelf support (E) under each side of each left shelf (D), as shown in *Figure 3*.
12. Cut one back (F) from 1/4" plywood, measuring 42-1/4" x 62-3/4".
13. With the armoire case lying on its front, apply glue to the back edges of the top/bottoms (A), sides (B) center divider (C), and shelves (D). With the help of a friend, lay the back (F) on the armoire case, matching all outside edges. Screw through the back (F) into the edges of the top/bottoms (A), sides (B) and center divider (C), using 1-inch screws spaced 6 inches apart.

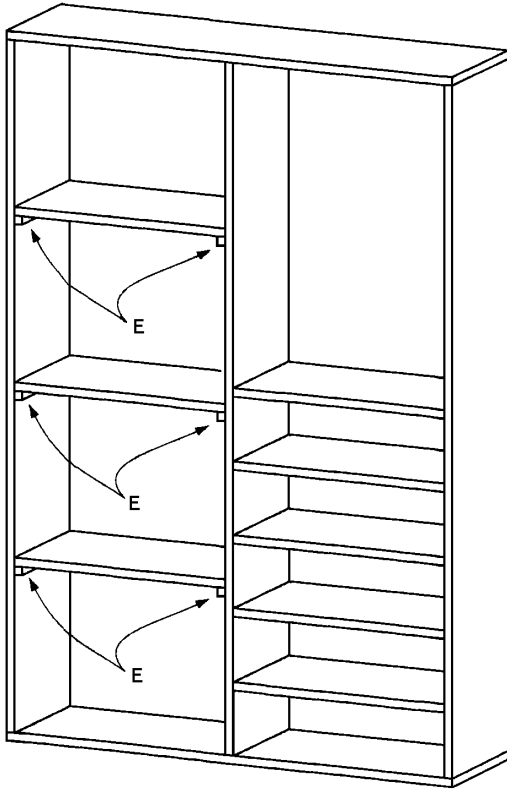

Figure 3

Adding the Trim

1. Cut four side trims (F) from 1 x 4 pine, each measuring 11-1/4 inches long.
2. Place the armoire case on its back on a level surface. Apply glue on the meeting surfaces, and screw one side trim (G) to the top of the armoire case, covering only the edge of the top/bottom (A), as shown in *Figure 4*. Screw through the side trim (F) into the top/bottom (A), using four evenly spaced 1-1/2-inch screws.
3. Repeat Step 2 three more times to attach the remaining three side trims (G) to the top/bottoms (A) on the bottom and top of the armoire case.
4. Cut two front trims (H) from 1 x 4 pine, each measuring 43-3/4 inches long.
5. Apply glue on the meeting surfaces, and screw one front trim (H) to the top front of the armoire case over the ends of the two side trims (G), as shown in *Figure 4*. Screw through the front trim (H) into the side trims (G) and the edge of the top/bottom (A) using 1-1/2-inch screws spaced every 5 inches.
6. Repeat Step 5 to attach the remaining front trim (H) to the bottom front of the armoire case.
7. The photograph shows the position of the crown molding (I) at the top and bottom of the armoire. Measure carefully and cut lengths of 3-inch-wide crown molding (I) to fit over the front and side trims (G and H), on both the bottom and top of the armoire case. The crown molding (I) should just barely cover the trims (G and H). Apply glue on the meeting surfaces and use 3/4-inch brads spaced about every four inches. If you are inexperienced at cutting crown molding, please refer to the “Tips and Techniques” section.

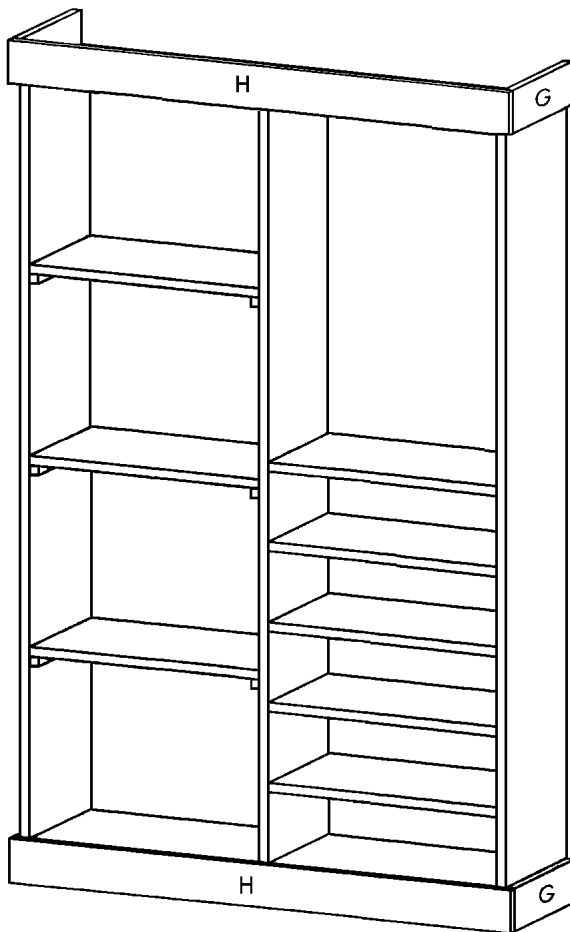

Figure 4

Making the Drawers

There are four identical drawers in this buffet. All four are constructed as shown in the assembly diagram in *Figure 5*.

1. Cut ten drawer front/back (J) from 1 x 6 pine, each measuring 19-7/8 inches long.
2. Cut a half-circle with a radius of 1-3/4" from the center of five of the front/back pieces. These now will be designated the drawer fronts.
3. Cut ten drawer sides (K) from 1 x 6 pine, each measuring 9-5/8 inches long.
4. Cut four drawer bottoms (L) from 1/4" plywood, measuring 10 x 18-3/4 inches.
5. Cut a 1/4 x 1/4-inch dado on the inside of each drawer piece (J and K) 3/8" from the lower edge to accommodate the plywood bottom.

6. Assemble one drawer as shown in *Figure 5*. Note that the drawer front/back pieces (J) overlap the ends of the drawer sides (K). Use two 2" 6d finishing nails through each end of the overlapping drawer front/back (J).
7. Repeat the drawer assembly four more times using the remaining eight drawer front/back pieces (J), the eight drawer sides (K), and the four drawer bottoms (L).

Making the Doors

1. Cut four top/bottom door trims (M) from 1 x 4 pine, each measuring 21 inches long.
2. Miter each of the four top/bottom door trims (M) at opposing 45-degree angles, as shown in *Figure 6*.

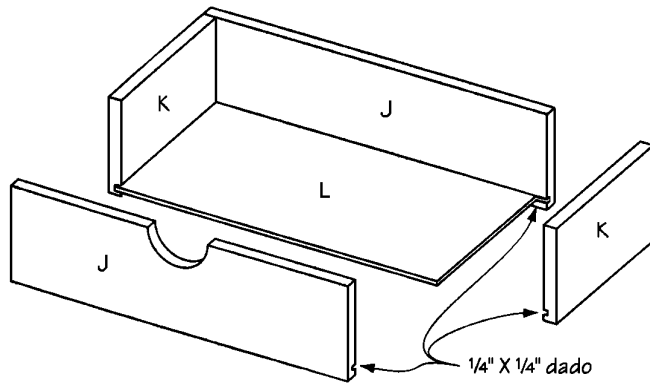

Figure 5

3. Cut four side door trims (N) from 1 x 4 pine, each measuring 61 inches long.
4. Miter each of the four side door trims (N) at opposing 45-degree angles, as shown in *Figure 6*.
5. Cut a 1/4 x 1/4 inch rabbet on the inside edges of the backs of the door trims (M and N), as shown in *Figure 6*.

6. Cut four door panels (O) from 1/4-inch plywood, each measuring 14-1/2" x 54-1/2".
7. Place two top/bottom door trims (M) fronts down, 54 inches apart, and parallel to each other. The miters should oppose each other, as shown in *Figure 7*.
8. Fit two side door trims (N) between the two top/bottom door trims (M), as shown in *Figure 7*. Apply glue on the mitered surfaces and to the rabbets. Lay one door panel into the rabbet and clamp the door assembly together. Nail through the door panel (O) at an angle into the door trims (M and N) using 3/4" brads spaced 4 inches apart. Reinforce the outside of each miter joint by driving one 1-1/4" 3d finishing nail across the joint from each edge, starting about 1 inch from the corner.

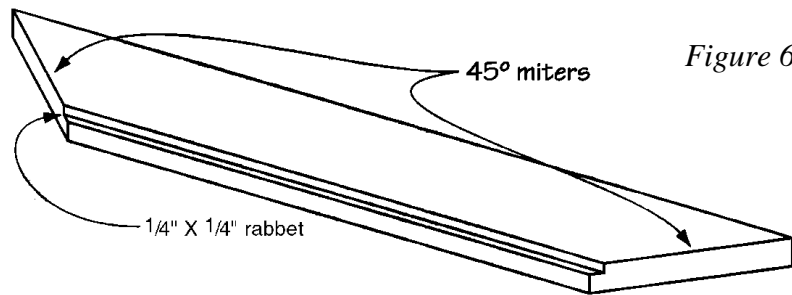

Figure 6

9. Repeat Steps 8 and 9 using the remaining two top/bottom door trims (M) and two side door trims (N) and door panel (O).

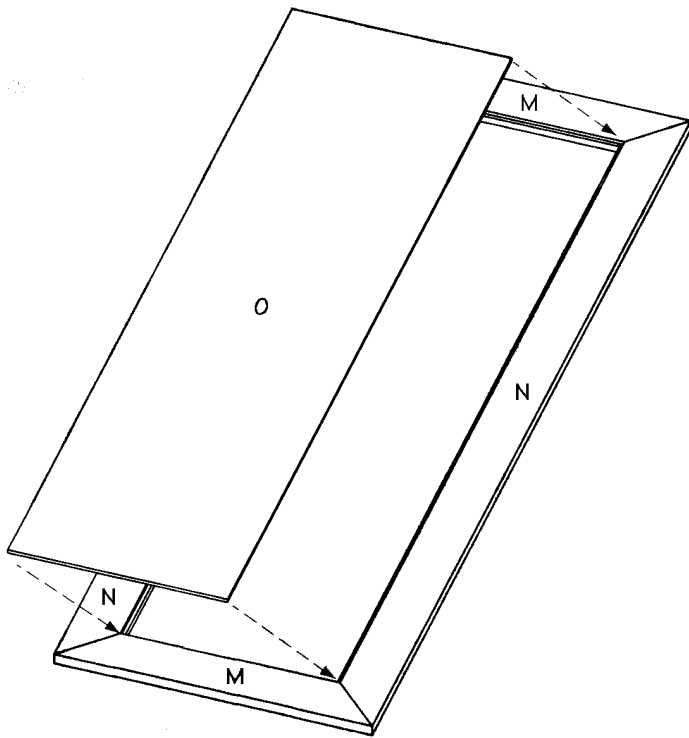

Figure 7

Finishing

1. Install the legs (P) in the four corners of the bottom of the armoire. Use three 3-inch screws driven through the bottom (A) into the top of each leg (P).
2. Fill the screw holes, crevices and cracks with wood filler.
3. Sand all surfaces of the completed armoire.
4. Install the cabinet doors on the completed armoire using three hinges on each door.
5. Install the closet rod (optional) on the right side of the armoire.
6. Stain or paint the armoire the color of your choice. We chose paint our armoire a bright white, and then sealed it with polyurethane.
7. Install the door pulls and catches.

**Other projects are available from
www.wowimadeit.com for your bedroom!**



The Daybed



Pine Bed



Nightstand